

ACCESSORIES

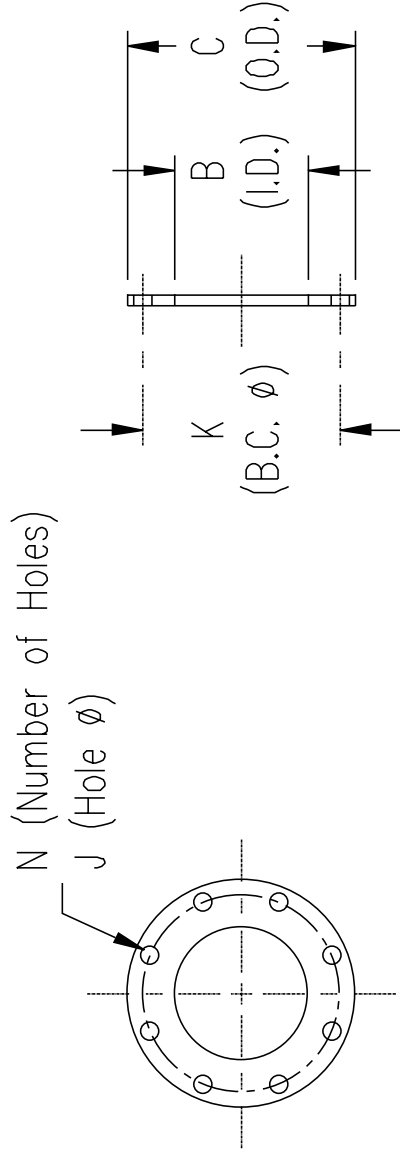

NOTES:

- 1) Oversized flanges of special design are available upon request.
- 2) Oversized flanges are welded in place unless otherwise specified.
- 3) One-size oversized flanges can be installed on either line or equipment connections.
- 4) Two-size oversized flanges are installed on line connections only.

DIMENSIONS AND WEIGHTS

NOMINAL SIZE	B (I.D.)	ONE-SIZE OVERSIZED FLANGES					TWO-SIZE OVERSIZED FLANGES						
		REFERENCE	C (O.D.)	K (B.C.)	HOLES N	J	WEIGHT	REFERENCE	C (O.D.)	K (B.C.)	HOLES N	J	WEIGHT
1	1 3/8	M150-B00010	4 5/8	3 1/2	4	5/8	1.5	M150-C00010	5	3 7/8	4	5/8	1.8
1 1/4	1 23/32	M150-B00012	5	3 7/8	4	5/8	1.7	M150-C00012	6	4 3/4	4	3/4	2.6
1 1/2	1 31/32	M150-B00015	6	4 3/4	4	3/4	2.5	M150-C00015	7	5 1/2	4	3/4	3.6
2	2 7/16	M150-B00020	7	5 1/2	4	3/4	3.4	M150-C00020	7 1/2	6	4	3/4	4.0
2 1/2	2 15/16	M150-B00025	7 1/2	6	4	3/4	3.8	M150-C00025	8 1/2	7	8	3/4	4.9
3	3 9/16	M150-B00030	8 1/2	7	8	3/4	4.6	M150-C00030	9	7 1/2	8	3/4	7.1
3 1/2	4 1/16	M150-B00035	9	7 1/2	8	3/4	6.7	M150-C00035	10	8 1/2	8	7/8	8.6
4	4 5/8	M150-B00040	10	8 1/2	8	7/8	8.1	M150-C00040	11	9 1/2	8	7/8	10.4
5	5 11/16	M150-B00050	11	9 1/2	8	7/8	9.2	M150-C00050	13 1/2	11 3/4	8	7/8	16.0
6	6 3/4	M150-B00060	13 1/2	11 3/4	8	7/8	14.5	M150-C00060	16	14 1/4	12	1	27.6
8	8 3/4	M150-B00080	16	14 1/4	12	1	23.3	M150-C00080	19	17	12	1	37.9
10	10 7/8	M150-B00100	19	17	12	1	32.1	M150-C00100	21	18 3/4	12	1 1/8	42.8
12	12 7/8	M150-B00120	21	18 3/4	12	1 1/8	36.2	M150-C00120	23 1/2	21 1/4	16	1 1/8	51.7
14	14 3/16	M150-B00140	23 1/2	21 1/4	16	1 1/8	46.8	M150-C00140	25	22 3/4	16	1 1/4	55.5
16	16 3/16	M150-B00160	25	22 3/4	16	1 1/4	47.1	M150-C00160	27 1/2	25	20	1 1/4	77.3
18	18 3/16	M150-B00180	27 1/2	25	20	1 1/4	65.9	M150-C00180	29 1/2	27 1/4	20	1 3/8	83.8
20	20 3/16	M150-B00200	29 1/2	27 1/4	20	1 3/8	71.0	M150-C00200	32	29 1/2	20	1 3/8	96.7
22	22 3/16	M150-B00220	32	29 1/4	20	1 3/8	82.5	M150-C00220	34 1/4	31 3/4	24	1 3/8	106.2
24	24 3/16	M150-B00240	34 1/4	31 3/4	24	1 3/8	90.7	M150-C00240	36 1/2	34	28	1 3/8	116.0
26	26 3/16	M150-B00260	36 1/2	34	28	1 3/8	99.2	M150-C00260	38 3/4	36	28	1 3/8	127.4
28	28 3/16	M150-B00280	38 3/4	36	28	1 3/8	109.3	M150-C00280	41 3/4	38 1/2	28	1 5/8	194.8
30	30 3/16	M150-B00300	41 3/4	38 1/2	28	1 5/8	168.8	M150-C00300	43 3/4	40 1/2	32	1 5/8	204.5