

# ACCESSORIES

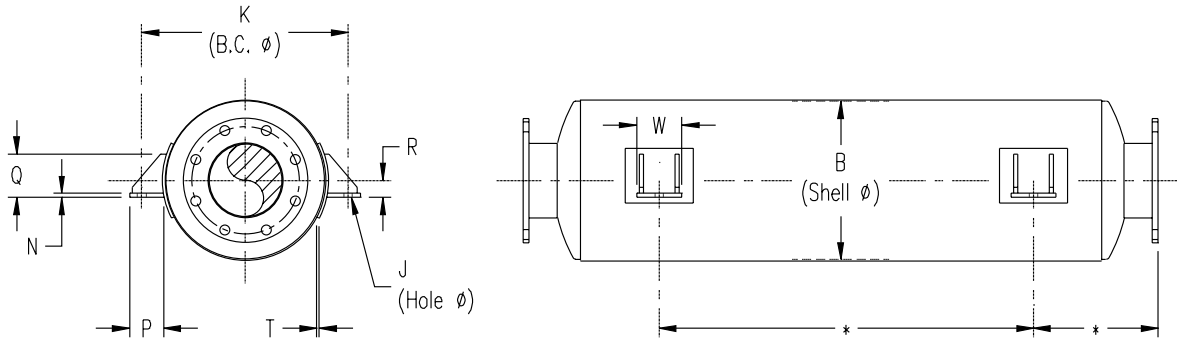

**NOTES:**

- 1) Shell lugs of special design are available upon request.
- 2) Shell lugs are welded in place unless otherwise specified.

\* Dimensions are optional within limits of the product's overall length - reference applicable Spec Sheet for details.

## DIMENSIONS AND WEIGHTS

B (SHELL DIA.)	REFERENCE	W	P	N	R	Q	T	J (HOLE DIA.)	K (B.C. DIA.)	WEIGHT (PER LUG)
8	S150-G00080	3	3	1/4	1 1/2	2 3/4	---	1/2	11	2
10	S150-G00100	3	3	3/8	1 1/2	2 7/8	1/4	5/8	13	3
12	S150-G00120	3	3	3/8	1 1/2	2 7/8	1/4	5/8	15	3
14	S150-G00140	4	4	3/8	1 1/2	3 7/8	1/4	3/4	18	4
16	S150-G00160	4	4	3/8	1 1/2	3 7/8	1/4	3/4	20	4
18	S150-G00180	4	4	3/8	1 1/2	3 7/8	1/4	3/4	22	4
20	S150-G00200	4	4	3/8	1 1/2	3 7/8	1/4	3/4	24	4
22	S150-G00220	4	4	3/8	1 1/2	3 7/8	1/4	3/4	26	4
24	S150-G00240	4	4	3/8	1 1/2	3 7/8	1/4	3/4	28	4
26	S150-G00260	4	4	1/2	1 1/2	4	3/8	1	30	7
28	S150-G00280	4	4	1/2	1 1/2	4	3/8	1	32	7
30	S150-G00300	4	4	1/2	3	4	3/8	1	34	7
32	S150-G00320	4	4	1/2	3	4	3/8	1	36	7
36	S150-G00360	4	4	1/2	3	4	3/8	1	40	7
42	S150-G00420	5	5	1/2	3	5	3/8	1 3/8	47	11
48	S150-G00480	5	5	1/2	3	5	3/8	1 3/8	53	11
54	S150-G00540	5	5	1/2	3	5	3/8	1 1/2	59	11
60	S150-G00600									
66	S150-G00660									
72	S150-G00720									

SHELL DIAMETERS ABOVE 54": AVAILABLE UPON REQUEST